

## EBLED2

### 2" CANS & TRIMS

#### STANDARD

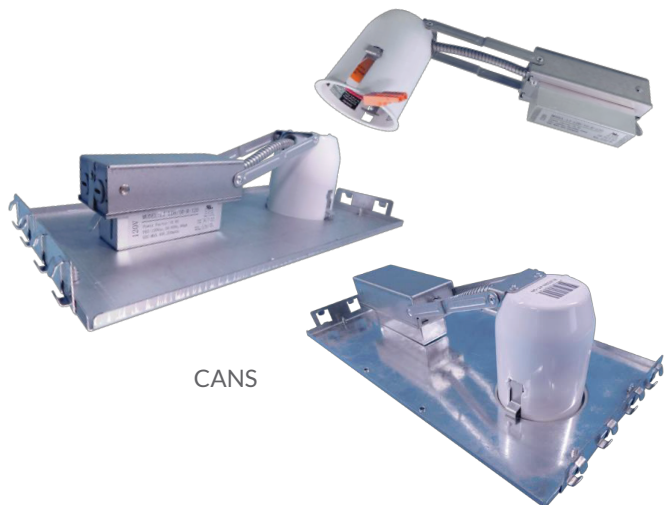

CANS



TRIMS

#### FEATURES

- Easy installation in new construction or retrofit applications
- For use with insulated and non-insulated ceilings
- EBLED2ICN requires access above ceiling
- Galvanized steel construction
- Integral T-bar installation slots on new construction models
- Remodel cans come standard with (2) clips to secure can to ceiling
- Bar hangers for use with new construction models are adjustable from 13.6" to 25"
- Pre-installed nail allows for easy install
- Input voltage = 120V
- Wattage = 9W
- Dimmable with most line voltage dimmers

#### FEATURES

- Available in 3000k (warm white), 3500k (warm/neutral white) and 4000k (neutral white) color temperatures\*
- Long-life LEDs provide at least 70% of initial lumen output ( $L_{70}$ ) for 50,000 hours of operation\*\*
- Provides 600 nominal lumens
- Color rendering index ( $R_a$ ) > 90

\*Contact factory for other color temperatures and lumen packages  
 \*\* $L_{70}$  hours are IES TM-21-11 calculated hours

#### WARRANTY / LISTING

- cULus listed for damp and wet locations
- Operating temperatures = -30°C to 40°C
- Complies with RoHS (Restriction on Hazardous Substances)
- Certified under ASTM-E283 for airtight construction (new construction models only)
- Energy Star qualified
- Title 24 compliant
- Complies with RoHS (Restriction on Hazardous Substances)
- 5-year warranty on all electronics and housing

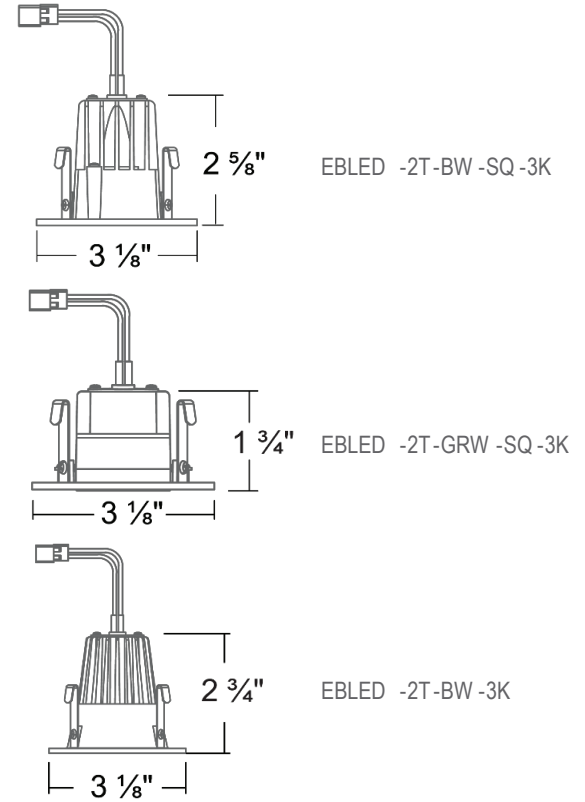
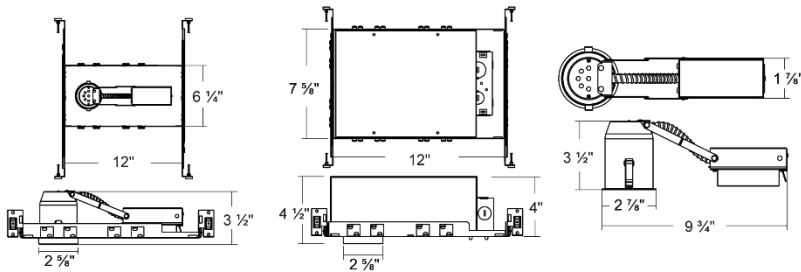

## ORDERING INFORMATION

### CANS

| MODEL           | DESCRIPTION                                    |
|-----------------|------------------------------------------------|
| EBLED2N-AT-QN   | 2" NON IC LED NEW CONSTRUCTION CAN WITH DRIVER |
| EBLED2ICN-AT-QN | 2" IC AT LED NEW CONSTRUCTION CAN WITH DRIVER  |
| EBLED2ICR-Q     | 2" NON-IC LED REMODEL CAN WITH DRIVER          |

### TRIMS

| MODEL              | DESCRIPTION                  |
|--------------------|------------------------------|
| EBLED-2T-BW-3K     | BAFFLE - WHITE, 3000K        |
| EBLED-2T-BW-35K    | BAFFLE - WHITE, 3500K        |
| EBLED-2T-BW-4K     | BAFFLE - WHITE, 4000K        |
| EBLED-2T-BW-SQ-3K  | SQUARE BAFFLE - WHITE, 3000K |
| EBLED-2T-BW-SQ-4K  | SQUARE BAFFLE - WHITE, 4000K |
| EBLED-2T-GRW-SQ-3K | SQUARE GIMBAL - WHITE, 3000K |
| EBLED-2T-GRW-SQ-4K | SQUARE GIMBAL - WHITE, 4000K |