

## EBOWRLQ

### AmberLED Stainless Steel Bollards



The LEPG AmberLED Bollards are available with cone reflector or louvers with 270° glare shield, and are certified by the Florida Fish & Wildlife Conservation Commission (FWC) for wildlife applications that are directly visible from the shore requiring monochromatic AMBER light. LEDs operate between 585 and 595 nm, greater than 560nm required by FWC. Typical applications include retail centers, hotels, residential, parks, schools and universities, office buildings and medical facilities.

#### Specifications and Features:

##### Housing:

Formed 316L Stainless Steel Housing with Flush Mounting Base & Vandal-Resistant Screws, Domed Top, Internal Ballast Tray for Easy Maintenance. Includes 270° Shield Required to Maintain FWC Certification.

##### Listing & Ratings:

CSA: Listed for Wet Locations, ANSI/UL 1598, 8750  
IP65 Sealed LED Compartment.

##### Style:

Specially Designed Aluminum Cone Reflector or Internal Louvers

##### Lens:

Clear Polycarbonate Vandal-Resistant Lens

##### Mounting Options:

Mounting Kit with 8" Anchor Bolts, Included.

##### AmberLED:

Aluminum Boards

##### Wattage:

Array: 14.5w, System: 17w; (70w HID Equivalent)

##### Driver:

Electronic Driver, 120-277V, 50/60Hz; Less Than 20% THD and PF>0.90. Standard Internal Surge Protection 2kV. 0-10V Dimming Standard for a Dimming Range of 100% to 10%; Dimming Source Current is 150 Microamps.

##### Warranty:

5-Year Warranty for -40°C to +40°C Environment.



#### Dimensions

Diameter (D)

7" (178mm)

Height (A)

41¾" (1,060mm)



**LED Cone Reflector**  
**BOWRLQ**

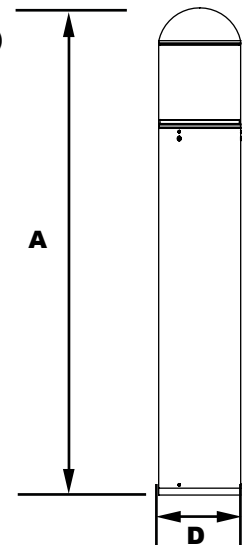

#### Order Information:

| AcXY  | Cdh]Wg                      | KUhhU[Y       | 8f]jYf      | 77H                | 7c'cf  | <Y][\h   | Cdh]cbg       |
|---|-----------------------------|---------------|-------------|--------------------|--|--|---------------|
| <b>ORGHO</b>  | <b>2SWLF</b>                | <b>EDWWDH</b> | <b>ULHU</b> | <b>&amp;&amp;7</b> | <b>&amp;RORU</b>   | <b>HLW</b>   | <b>2SWLRQ</b> |
| E6CKF@E1FcibX 8caY<br>6c`UfX k]h\ @E8 7cbY<br>FYZYWhcf UbX &+\$s G\YX<br>E6CK@E1FcibX 8caY<br>6c`UfX k]h\ @c i jYfg UbX &+\$s<br>G\YX | :1K]XY 6YUa GdfYU %L%)1%) k | I 1%&!!&+J    | 5A15 aVYf   | GG1GhU]b`Ygg GhY`  | f@YUjY 6`Ub_L1<br>(&` GhUbXUfX<br><Y][\h `*1`*`<br><Y][\h '\$1'\$`<br><Y][\h | G:1G]b`Y : igY<br>8:18ciVY : igY<br>GD1Gif[Y DfchYWh]cb<br>; :%1 ; :7= Cih`YhZ<br>%) 5z%&\$J 6 I 16UhhYfm<br>6UW_idz -\$ A]bihYg |               |

07.2019

Job Name: \_\_\_\_\_

Type: \_\_\_\_\_

Part #: \_\_\_\_\_

Notes: \_\_\_\_\_

### Accessories & Replacement Parts:

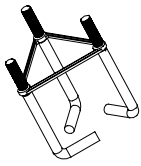

BOLAN

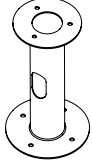

BOLRM



BREBASE\*

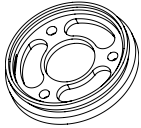

BORBASE



BOADP1

\*Shown Mounted

| Mounting Accessories<br>(Order Separately, Field Installed) |  |
|---|--|
| BOLAN4  | Mounting Kit, Includes Bracket & Three (3) 4" Anchor Bolts   |
| BOLAN8  | Mounting Kit, Includes Bracket & Three (3) 8" Anchor Bolts   |
| BOLAN12   | Mounting Kit, Includes Bracket & Three (3) 12" Anchor Bolts  |
| BOLAN15   | Mounting Kit, Includes Bracket & Three (3) 15" Anchor Bolts  |
| BOLRM   | Root Mount Kit   |
| BREBASE*  | Bollard Retrofit Base Kit Adapts New Bollards to Most Existing Bolt Patterns. Fits all LEPC Bollards. Die Cast with Powdercoat Finish, Hardware Included. 1 1/2" Dia. x 1 1/2" H |

\*Specify Color: Z=Bronze, B=Black, C=Custom (Consult Factory)

| Replacement Parts<br>(Order Separately, Field Installed) |  |
|--|--|
| BORBASE*   | Die Cast Base Plate with Powdercoat Finish Over a Chromate Conversion Coating.                                 |
| BOADP1   | Adapter Plate with Gaskets for Outlet Boxes. Fits LEPC Round Bollards. Die Cast with Bronze Powdercoat Finish. |

\*Specify Color: Z=Bronze, B=Black

For Replacement Battery Backup, see the LEPC LED Battery Backup Specification Sheet.

### Photometric Data

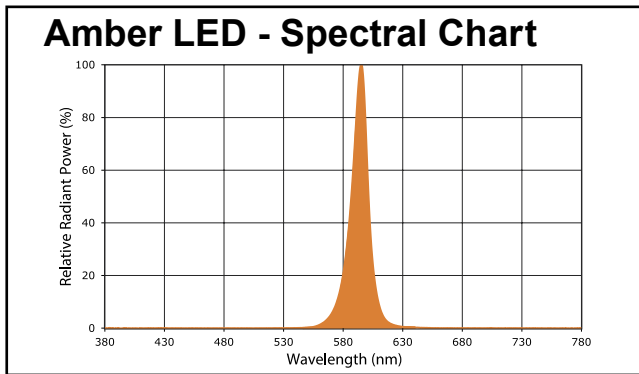

### Projected Lumen Maintenance

| Data shown for Amber LEDs            |             |         | Compare to MH |            |             |                      |
|--------------------------------------|-------------|---------|---------------|------------|-------------|----------------------|
| TM-21-11                             | Input Watts | Initial | 25,000 Hrs    | 50,000 Hrs | 100,000 Hrs | Calculated L70@ 25°C |
| L70 Lumen Maintenance @ 25°C / 77°F  | 17          | 1.00    | 0.95          | 0.90       | 0.80        | 147,000              |
| TM-21-11                             | Input Watts | Initial | 25,000 Hrs    | 50,000 Hrs | 100,000 Hrs | Calculated L70@ 50°C |
| L70 Lumen Maintenance @ 50°C / 122°F | 17          | 1.00    | 0.89          | 0.78       | 0.55        | 67,000               |
| TM-21-11                             | Input Watts | Initial | 25,000 Hrs    | 50,000 Hrs | 100,000 Hrs | Calculated L80@ 40°C |
| L80 Lumen Maintenance @ 40°C / 104°F | 17          | 1.00    | 0.92          | 0.85       | 0.70        | 66,000               |

**NOTES:**

- Projected per IESNA TM-21-11. Data references the extrapolated performance projections for the 116mA base model in a 25°C ambient, based on 10,000 hours of LED testing per IESNA LM-80-08.
- Compare to MH box indicates suggested Light Loss Factor (LLF) to be used when comparing to Metal Halide (MH) systems.